

# CoviRAT

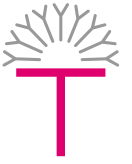

## RAPID ANTIGEN TEST *for* COVID-19

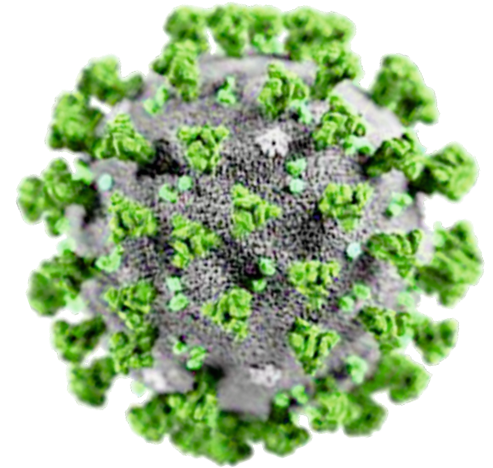
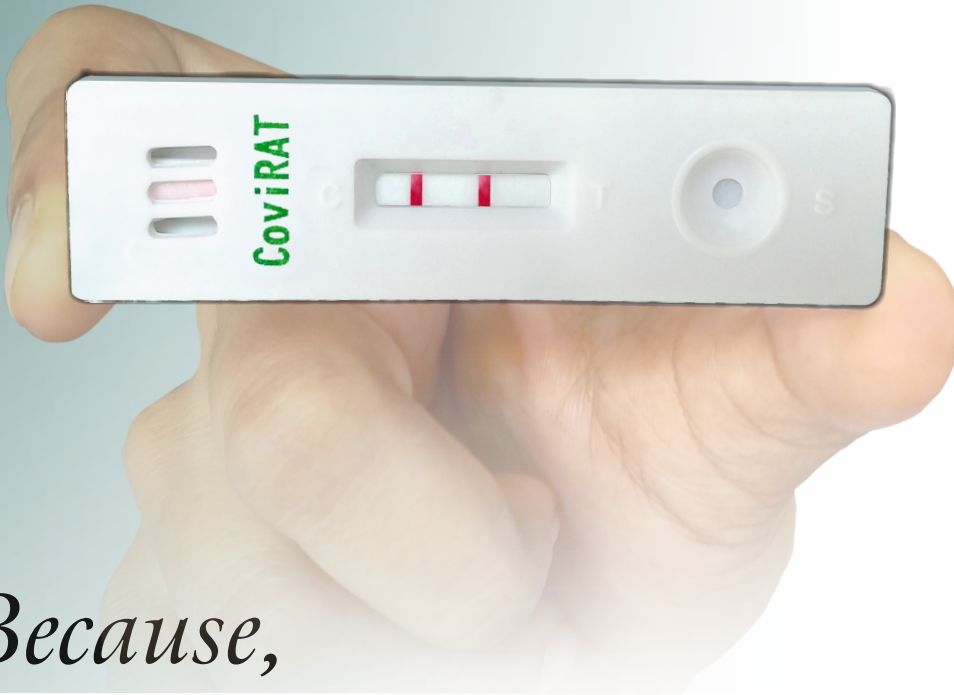

*Because,*

Only **Sensitivity** Matters!



In comparison with RT-PCR confirmed specimen

	Sensitivity	Specificity
Evaluation in USA	96.3%	100 %
Evaluation in India (RT-PCR positive specimens with Ct<30)	95.4%	96.36%

## Highest Correlation with RT-PCR Test



# CoviRAT™

## Rapid Test for Detection of SARS-CoV-2 Antigen in Human Nasopharyngeal Swab Specimens

CoviRAT™ is an in-vitro, rapid, qualitative immunoassay for the detection of nucleocapsid protein antigens expressed by the SARS-CoV-2 virus present in human nasopharyngeal swab specimen. It is to be used for screening or to aid in the diagnosis of COVID-19 and takes 15-30 minutes for producing test result.

Rapid antigen tests are known to be sensitive enough to detect clinical cases, i.e. pre-symptomatic and early symptomatic cases (up to five days from symptom onset; or low RT-PCR cycle threshold (Ct) value <30), which likely account for a significant proportion of transmissions. The use of sensitive and specific rapid antigen test is appropriate in high prevalence areas as well as in low prevalence areas to identify the infectious positive cases. Rapid antigen tests can help reduce further transmission through early identification of positive cases, enabling a faster contact tracing.

FEATURES	BENEFITS
<b>Double Antibody Sandwich Assay.</b>	Detects nucleocapsid protein antigens expressed by SARS-CoV-2 virus.
<b>Monoclonal antibodies used in both capture and tracer part.</b>	Ensures specific detection and timely isolation of the infected person.
<b>Nasopharyngeal specimen can be used.</b>	Facilitates higher volume testing at the patient site and in laboratory setup.
<b>Rapid Antigen Detection Test.</b>	Results in 15-30 minutes.
<b>Sterile Breakable nasopharyngeal swabs.</b>	Minimizes exposure. Ease of use.
<b>Sensitivity 96.3%*</b> <b>Specificity 100%</b>	Highly Sensitive and Accurate test result ; compared to RT-PCR !

\*USA Evaluation, Data on file Tulip Diagnostics (P) Ltd.

<b>Pack size</b>	<b>Cat. No.</b>
<b>25 Tests</b>	<b>502100025</b>

### INTERPRETATION OF RESULTS



**Negative for**  
SARS-CoV-2 antigen in the specimen



**Positive for**  
SARS-CoV-2 antigen in the specimen



**Invalid Result**  
Repeat the test



### TEST PROCEDURE

#### STEP 1

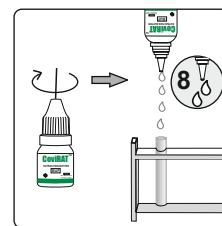

Open Extraction Buffer bottle.  
Dispense **8 drops** into Extraction Buffer tube.

#### STEP 2

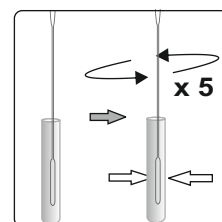

Insert the swab with the specimen into the Extraction Buffer tube.  
Swirl the swab **5 times** to extract the specimen completely.

#### STEP 3

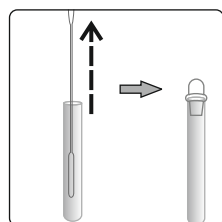

Remove the swab and discard.  
Cap the Extraction Buffer tube.

#### STEP 4

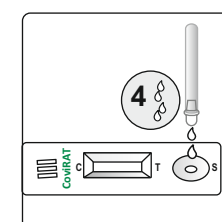

Dispense **4 drops** of specimen from the Extraction Buffer tube into the Buffer port (S).

#### STEP 5

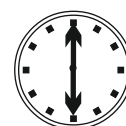

Read the results in 15-30 Minutes.  
Do not read the results beyond 30 Minutes.

ISO 13485  
Certified Company



**TULIP DIAGNOSTICS (P) LTD.**

Gitanjali, Tulip Block, Dr. Antonio do Rego Bagh, Alto Santacruz, Bambolim Complex Post Office, Goa - 403 202, INDIA.  
Tel.: +91 832 2458546-50 Fax : +91 832 2458544 E-mail : sales@tulipgroup.com Website : www.tulipgroup.com